

TYPICAL CONSTRUCTION DETAIL FOR MASONRY FENCE WALL

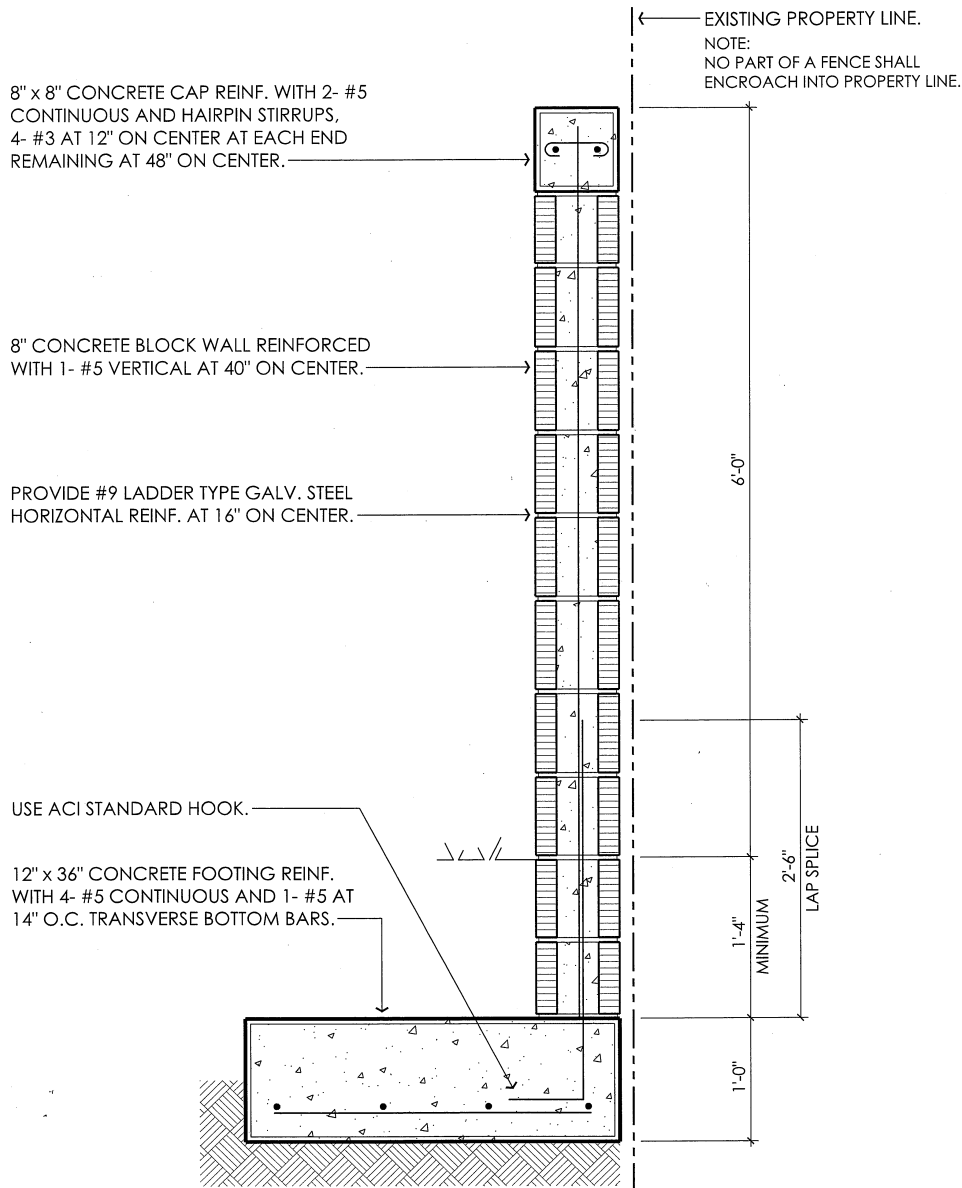

MASONRY FENCE WALL DETAIL

N.T.S.

NOTE: A FOUNDATION/HOLE INSPECTION SHALL BE REQUIRED PRIOR TO CONCRETE POUR.

IMPORTANT FOR USE AS A POOL BARRIER

Outdoor swimming pools shall be provided with a barrier complying with Florida building Code Sections 424.2.17.1.1 through 424.2.17.1.14.

Access gates shall be equipped with a self-closing, self-latching locking device located no less than 54 inches from the bottom of the gate. The device release mechanism shall be located on the pool side of the gate and so placed that it cannot be reached by a young child over the top or through any opening or gap. Gates that provide access to the swimming pool must open outward away from the pool.

The top of the barrier shall be at least 48 inches above grade measured on the side of the barrier which faces away from the swimming pool.