

**SOUTH ROYAL POINCIANA
 CITY OF MIAMI SPRINGS, MIAMI-DADE, FLORIDA**
 SOUTH ROYAL POINCIANA BLVD, MIAMI SPRINGS, FLORIDA
 AHCA: 23/100154-267-1

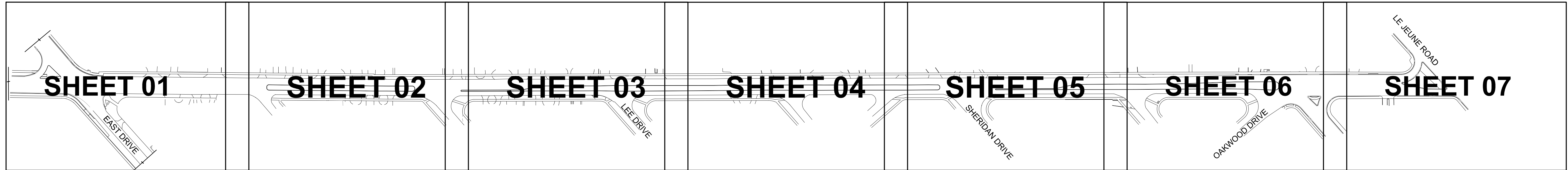

PHASE:
**SITE PLAN REVIEW
 100% SUBMISSION**

Note: This drawing is protected by copyright. It shall not be transmitted to any other except as agreed to by the Architect/Engineers

SEAL:

REVISIONS:

No.	DESCRIPTION	DATE

TITLE:
**SHEET
 KEY PLAN**

Project No:
 Date: 06/03/2022
 Scale:
 Format: 24" x 36"
 Drawn: RL
 Checked: KJO

SHEET:
LL-00

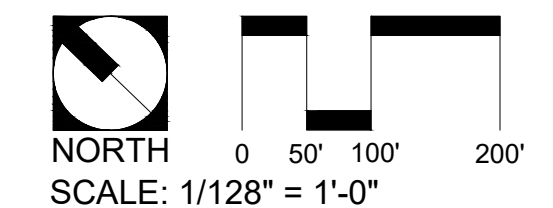

**SOUTH ROYAL POINCIANA
 CITY OF MIAMI SPRINGS, MIAMI-DADE, FLORIDA**

SOUTH ROYAL POINCIANA BLVD, MIAMI SPRINGS, FLORIDA
 AHCA: 23/100154-267-1

PHASE:
**SITE PLAN REVIEW
 100% SUBMISSION**

Note: This drawing is protected by
 copyright. It shall not be transmitted to
 any other except as agreed to by the
 Architect/Engineers

SEAL:

REVISIONS:

No.	DESCRIPTION	DATE

TITLE:
LANDSCAPE PLAN

Project No:
 Date: 06/03/2022
 Scale: 1" = 20'
 Format: 24" x 36"
 Drawn: RL
 Checked: KJO
 SHEET:

LL-01

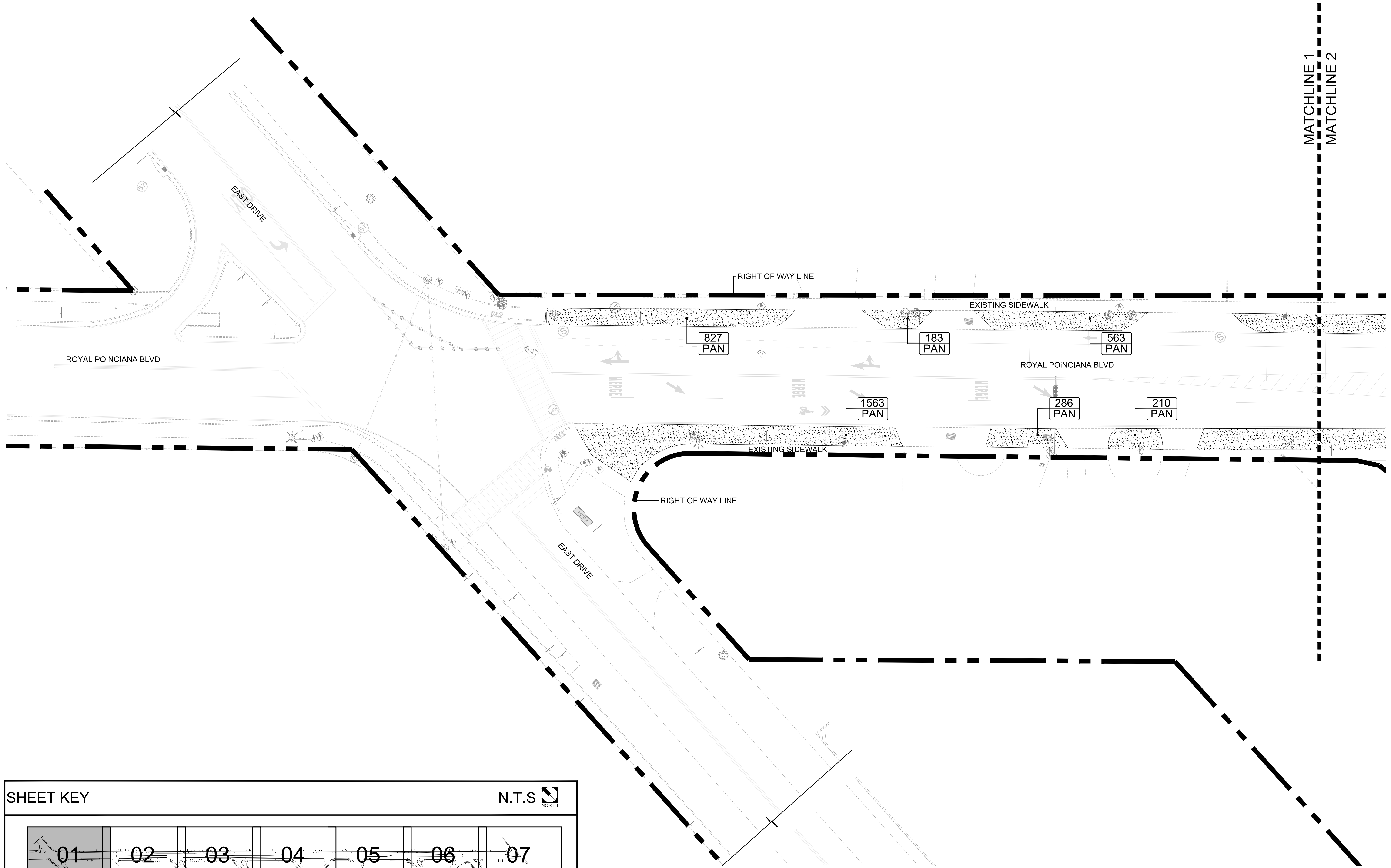

SHEET KEY N.T.S.

	01		02		03		04		05		06		07
--	----	--	----	--	----	--	----	--	----	--	----	--	----

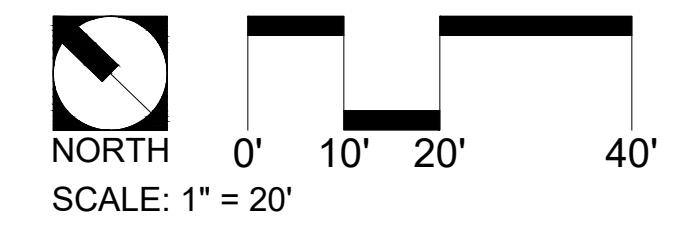

**SOUTH ROYAL POINCIANA
 CITY OF MIAMI SPRINGS, MIAMI-DADE, FLORIDA**

SOUTH ROYAL POINCIANA BLVD, MIAMI SPRINGS, FLORIDA
 AHCA: 23/100154-267-1

PHASE:
**SITE PLAN REVIEW
 100% SUBMISSION**

Note: This drawing is protected by copyright. It shall not be transmitted to any other except as agreed to by the Architect/Engineers

SEAL:

REVISIONS:

No.	DESCRIPTION	DATE

TITLE:

LANDSCAPE PLAN

Project No:
 Date: 06/03/2022
 Scale: 1" = 20'
 Format: 24" x 36"
 Drawn: RL
 Checked: KJO
 SHEET:

LL-02

MATCHLINE 1
 MATCHLINE 2

MATCHLINE 2
 MATCHLINE 3

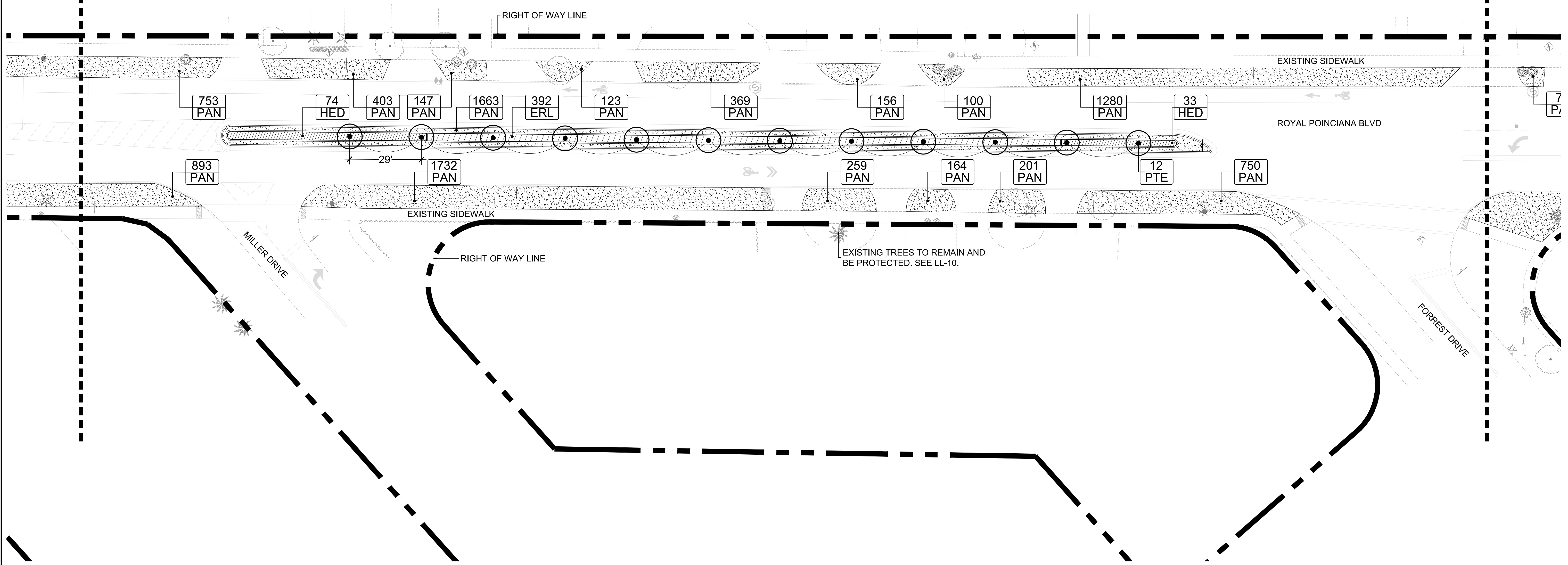

SHEET KEY N.T.S.

--	--	--	--	--	--	--

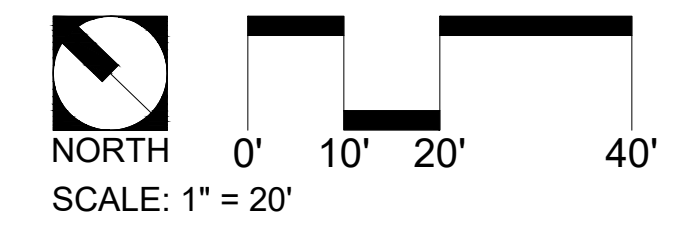

**SOUTH ROYAL POINCIANA
 CITY OF MIAMI SPRINGS, MIAMI-DADE, FLORIDA**

SOUTH ROYAL POINCIANA BLVD, MIAMI SPRINGS, FLORIDA
 AHCA: 23/100154-267-1

PHASE:
**SITE PLAN REVIEW
 100% SUBMISSION**

Note: This drawing is protected by copyright. It shall not be transmitted to any other except as agreed to by the Architect/Engineers

SEAL:

REVISIONS:

No.	DESCRIPTION	DATE

TITLE:
LANDSCAPE PLAN

Project No:
 Date: 06/03/2022
 Scale: 1" = 20'
 Format: 24" x 36"
 Drawn: RL
 Checked: KJO
 SHEET:

LL-03

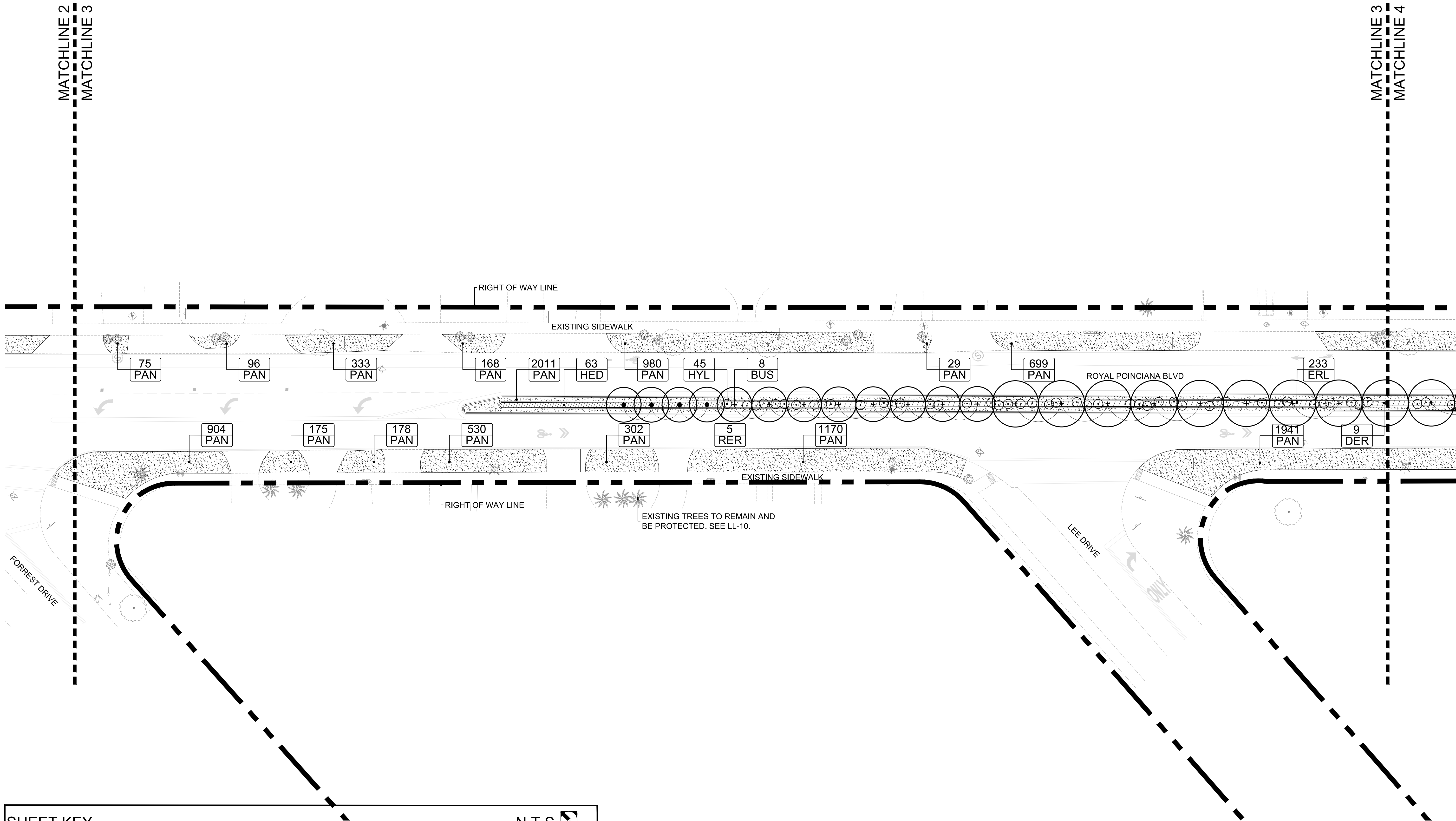

SHEET KEY N.T.S.

	01		02		03		04		05		06		07
--	----	--	----	--	----	--	----	--	----	--	----	--	----

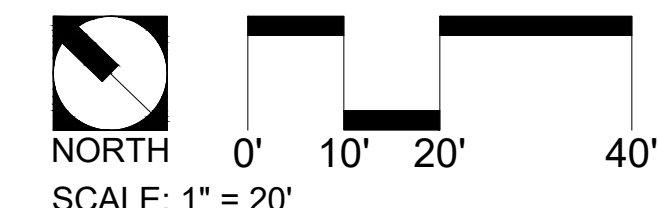

**SOUTH ROYAL POINCIANA
 CITY OF MIAMI SPRINGS, MIAMI-DADE, FLORIDA**

SOUTH ROYAL POINCIANA BLVD, MIAMI SPRINGS, FLORIDA
 AHCA: 23/100154-267-1

PHASE:
**SITE PLAN REVIEW
 100% SUBMISSION**

Note: This drawing is protected by copyright. It shall not be transmitted to any other except as agreed to by the Architect/Engineers

SEAL:

REVISIONS:
 No. DESCRIPTION DATE:

No.	DESCRIPTION	DATE

TITLE:

LANDSCAPE PLAN

Project No:
 Date: 06/03/2022
 Scale: 1" = 20'
 Format: 24" x 36"
 Drawn: RL
 Checked: KJO
 SHEET:

LL-04

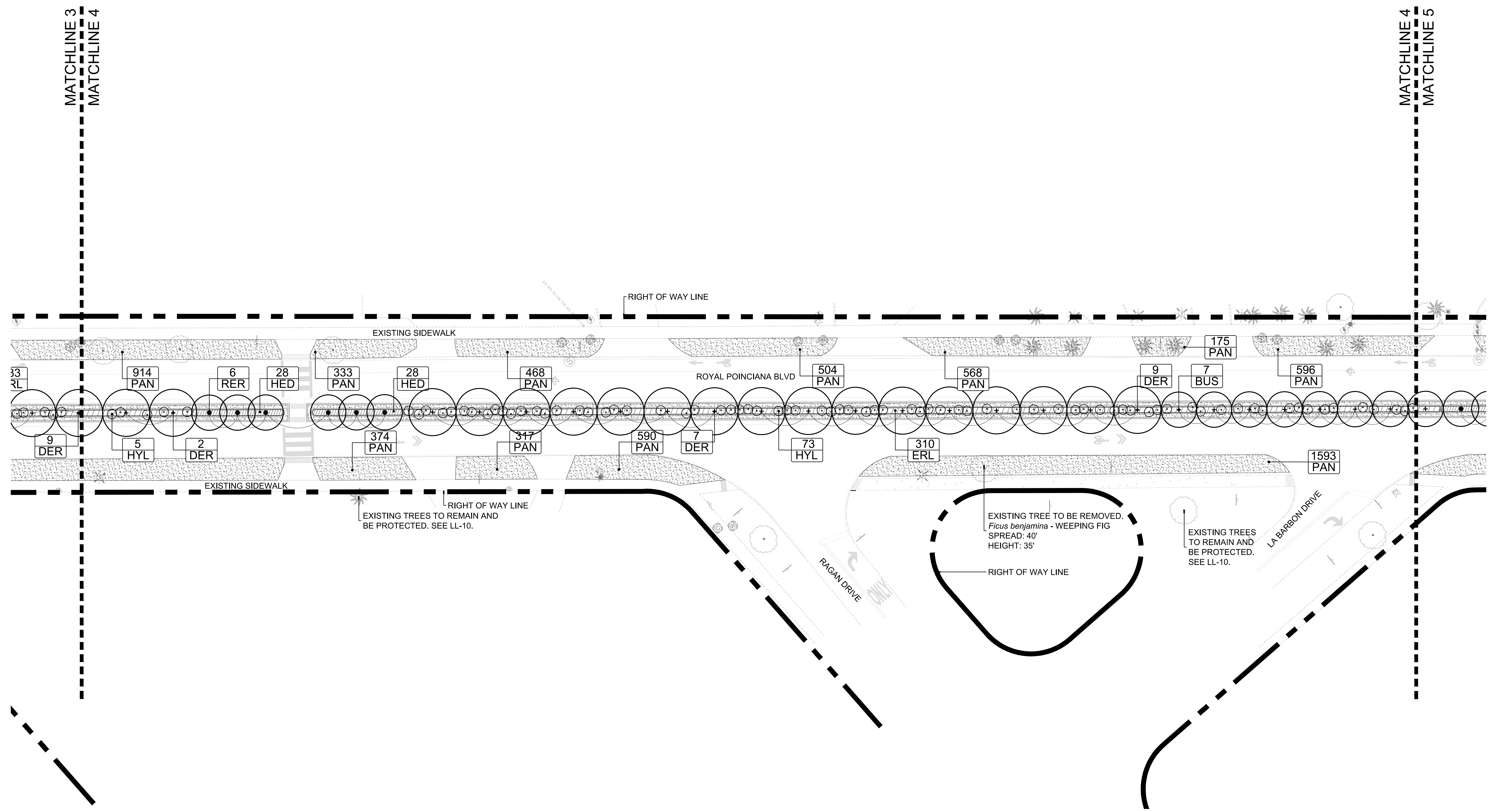

SHEET KEY N.T.S.

	01		02		03		04		05		06		07
--	----	--	----	--	----	--	----	--	----	--	----	--	----

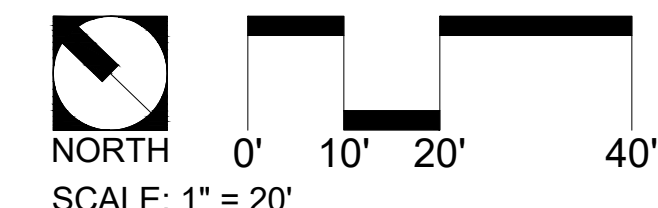

**SOUTH ROYAL POINCIANA
 CITY OF MIAMI SPRINGS, MIAMI-DADE, FLORIDA**

SOUTH ROYAL POINCIANA BLVD, MIAMI SPRINGS, FLORIDA
 AHCA: 23/100154-267-1

PHASE:
**SITE PLAN REVIEW
 100% SUBMISSION**

Note: This drawing is protected by copyright. It shall not be transmitted to any other except as agreed to by the Architect/Engineers

SEAL:

REVISIONS:

No.	DESCRIPTION	DATE

TITLE:
LANDSCAPE PLAN

Project No:
 Date: 06/03/2022
 Scale: 1" = 20'
 Format: 24" x 36"
 Drawn: RL
 Checked: KJO
 SHEET:

LL-05

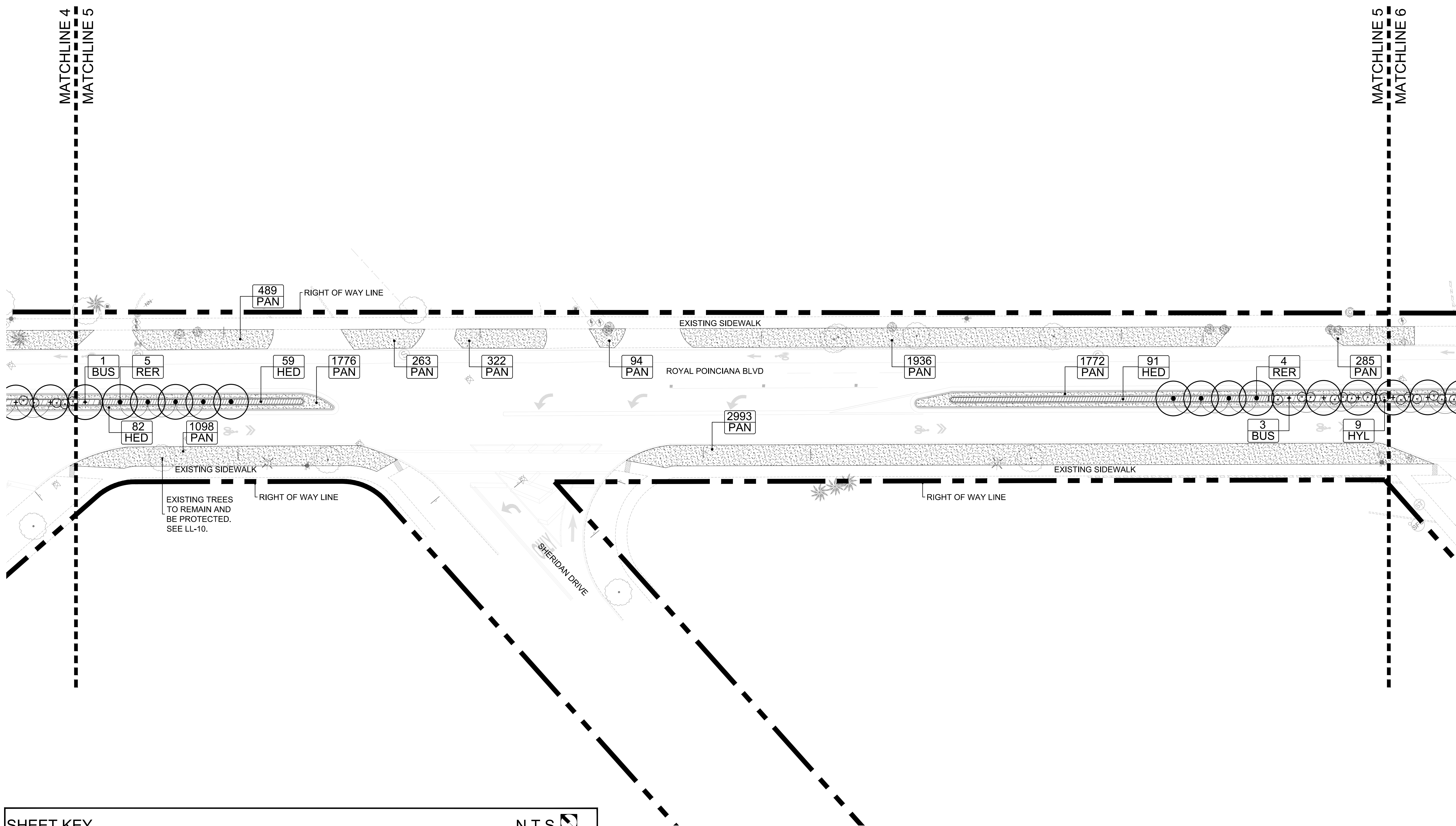

SHEET KEY N.T.S.

--	--	--	--	--	--	--

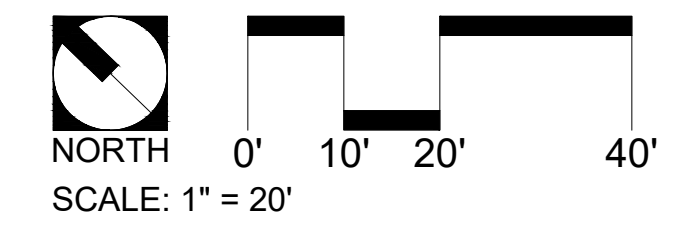

**SOUTH ROYAL POINCIANA
 CITY OF MIAMI SPRINGS, MIAMI-DADE, FLORIDA**

SOUTH ROYAL POINCIANA BLVD, MIAMI SPRINGS, FLORIDA
 AHCA: 23/100154-267-1

PHASE:
**SITE PLAN REVIEW
 100% SUBMISSION**

Note: This drawing is protected by copyright. It shall not be transmitted to any other except as agreed to by the Architect/Engineers

SEAL:

REVISIONS:
 No. DESCRIPTION DATE:

No.	DESCRIPTION	DATE

TITLE:

LANDSCAPE PLAN

Project No:
 Date: 06/03/2022
 Scale: 1" = 20'
 Format: 24" x 36"
 Drawn: RL
 Checked: KJO
 SHEET:

LL-06

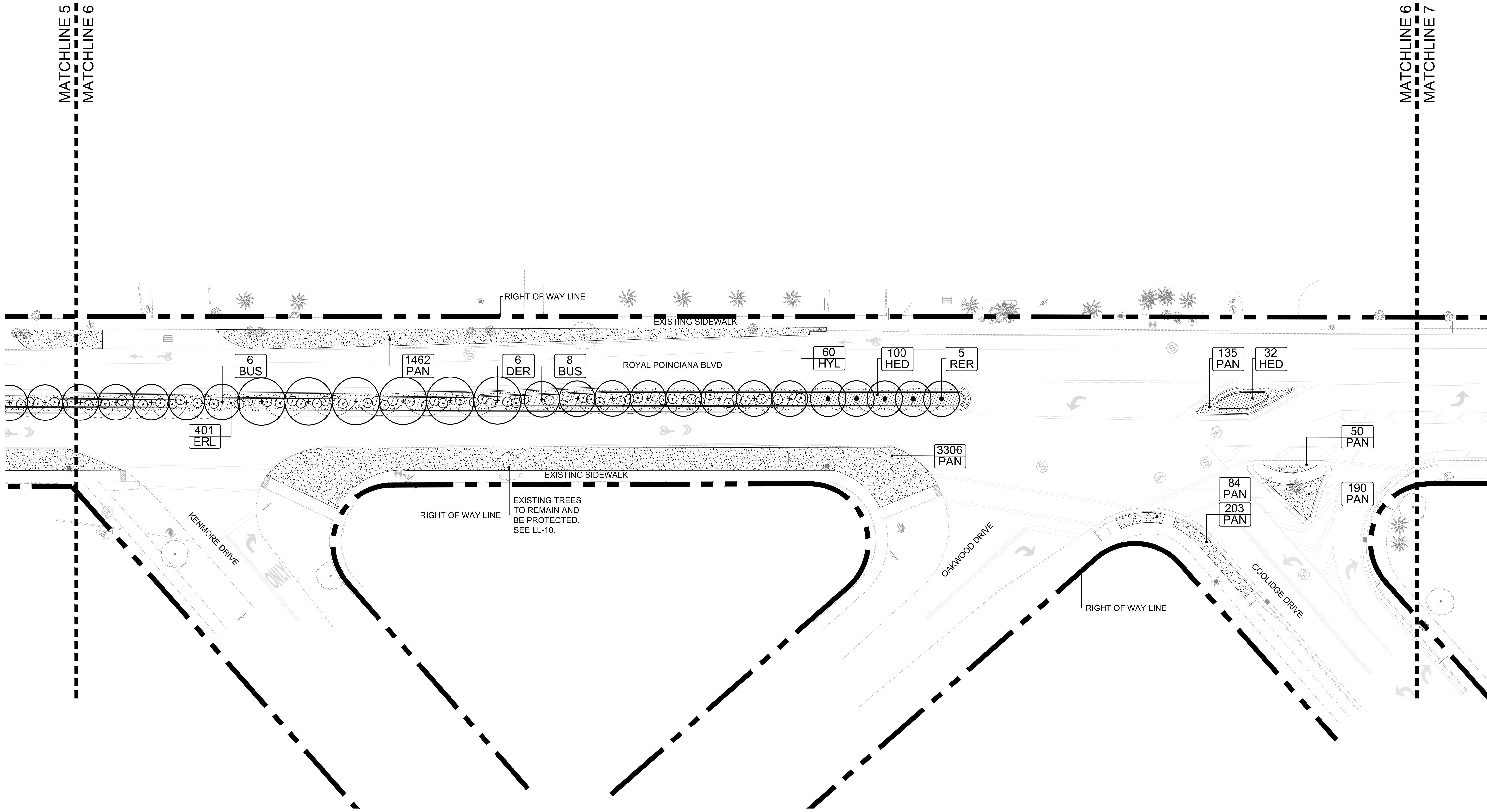

SHEET KEY N.T.S.

01	02	03	04	05	06	07
----	----	----	----	----	----	----

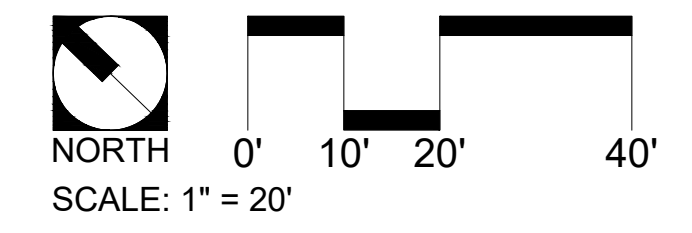

**SOUTH ROYAL POINCIANA
 CITY OF MIAMI SPRINGS, MIAMI-DADE, FLORIDA**

SOUTH ROYAL POINCIANA BLVD, MIAMI SPRINGS, FLORIDA
 AHCA: 23/100154-267-1

PHASE:
**SITE PLAN REVIEW
 100% SUBMISSION**

Note: This drawing is protected by copyright. It shall not be transmitted to any other except as agreed to by the Architect/Engineers

SEAL:

REVISIONS:

No.	DESCRIPTION	DATE

TITLE:
LANDSCAPE PLAN

Project No:
 Date: 06/03/2022
 Scale: 1" = 20'
 Format: 24" x 36"
 Drawn: RL
 Checked: KJO
 SHEET:

LL-07

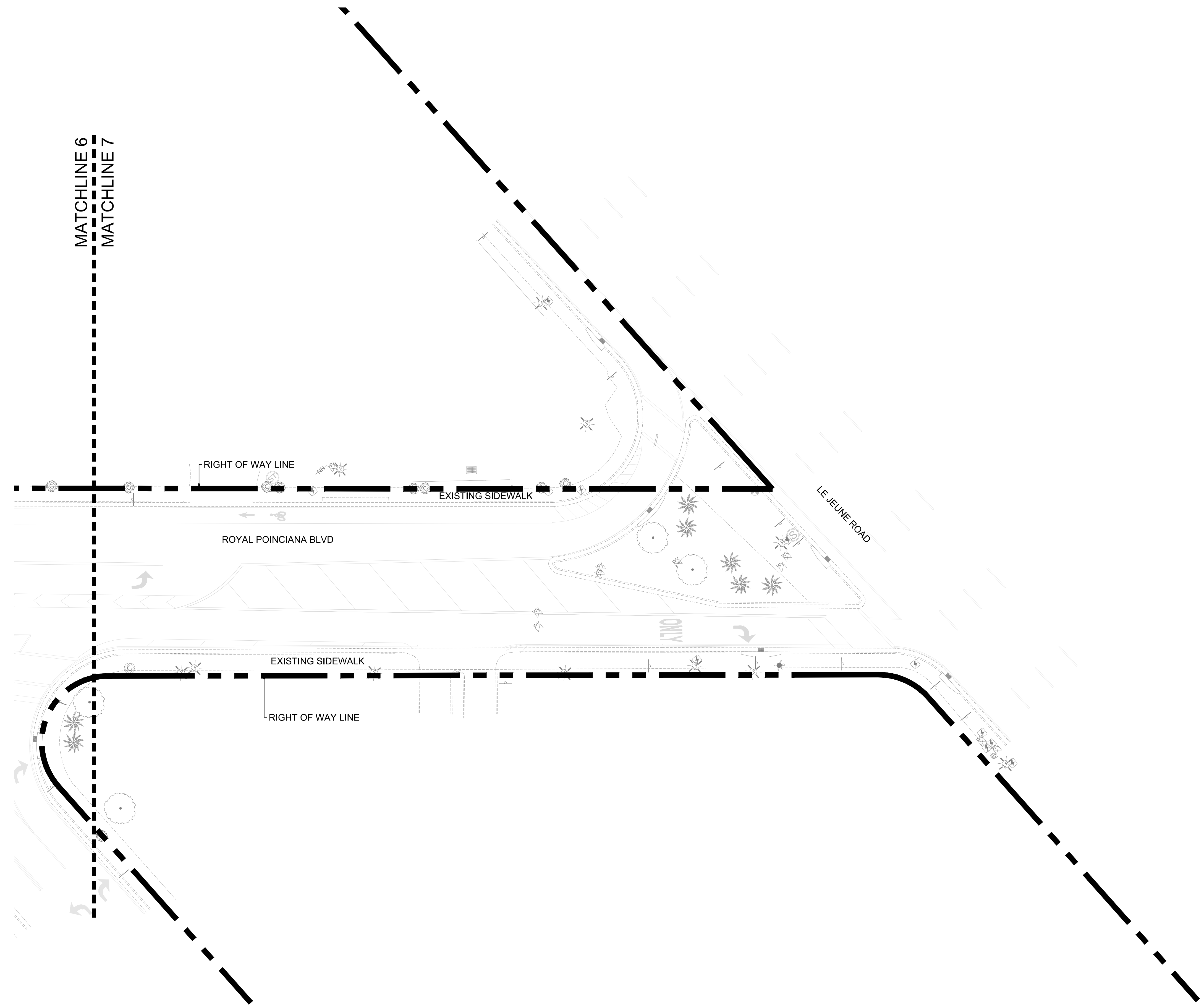

SHEET KEY N.T.S.

	01		02		03		04		05		06		07
--	----	--	----	--	----	--	----	--	----	--	----	--	----

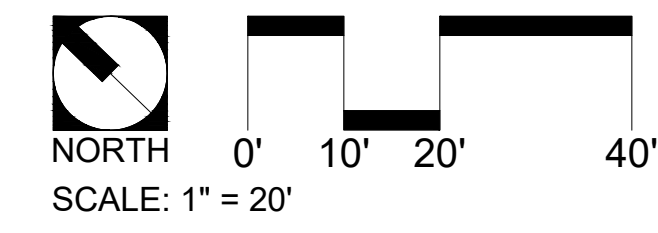

CANOPY TREES

SYMBOL	QUANTITY	BOTANICAL NAME	COMMON NAME	INSTALLATION SPECIFICATIONS							TYPICAL MATURE SIZE			ENVIRONMENTAL TOLERANCES		NATIVE
				HEIGHT	SPREAD	DBH	CLEAR TRUNK	ROOT BALL	SPACING	ADDITIONAL SPECIFICATION	HEIGHT	SPREAD	TRUNK DIAMETER	DROUGHT	WIND	
BUS	32	<i>Bursera simaruba</i>	Gumbo Limbo	16' tall	8' wide	5" caliper	8'	B&B	As Shown	N/A	50' tall	70' wide	36" caliper	High	Moderate	Yes
DER	33	<i>Delonix regia</i>	Royal Poinciana	15' tall	15' wide	4" caliper	7'	B&B	As Shown	N/A	50' tall	50' wide		Moderate	Moderate	No

PALMS

SYMBOL	QUANTITY	BOTANICAL NAME	COMMON NAME	INSTALLATION SPECIFICATIONS							TYPICAL MATURE SIZE			ENVIRONMENTAL TOLERANCES		NATIVE
				HEIGHT	SPREAD	CAL. AT 6" ABOVE GRADE	GRAY WOOD	ROOT BALL	SPACING	ADDITIONAL SPECIFICATION	HEIGHT	SPREAD	TRUNK DIAMETER	DROUGHT	WIND	
PTE	12	<i>Ptychosperma elegans</i>	Solitaire Palm	30' tall	10' wide	N/A	14'	B&B	Full head matched	NA	30'	15'	5"	Low	Low	No
RER	24	<i>Roystonea elata</i>	Florida Royal Palm	30' tall	25'	30"	15' to 25'	B&B	full 270° head matched	full 270° head	70' tall	25' wide	30"	Low	Moderate	Yes

SHRUBS & GROUNDCOVERS

SYMBOL	QUANTITY	BOTANICAL NAME	COMMON NAME	INSTALLATION SPECIFICATIONS							TYPICAL MATURE SIZE			ENVIRONMENTAL TOLERANCES		NATIVE
				HEIGHT	SPREAD	CAL. AT 6" ABOVE GRADE	CLEAR TRUNK	CONTAINER	SPACING	ADDITIONAL SPECIFICATION	HEIGHT	SPREAD	TRUNK DIAMETER	DROUGHT	WIND	
ERL	1,336	<i>Ermodea littoralis</i>	Golden Creeper	12" tall	12" wide	N/A	N/A	1 gallon	24" O.C.	N/A	3' tall	3' tall	N/A	High	High	Yes
HED	508	<i>Helianthus debilis</i>	Beach Sunflower	12" tall	12" wide	N/A	N/A	1 gallon	24" O.C.	Full to the Ground	3' tall	6' wide	N/A	Moderate	Moderate	Yes
HYL	192	<i>Hymenocallis latifolia</i> 'Spider Lily'	Spider Lily	18" tall	18" wide	N/A	N/A	3 gallon	As Shown	N/A	3' tall	5' wide	N/A	High	Low	Yes

SOD

SYMBOL	QUANTITY	BOTANICAL NAME	COMMON NAME	INSTALLATION SPECIFICATIONS							TYPICAL MATURE SIZE			ENVIRONMENTAL TOLERANCES		NATIVE
				HEIGHT	SPREAD	CAL. AT 6" ABOVE GRADE	GRAY WOOD	ROOT BALL	SPACING	ADDITIONAL SPECIFICATION	HEIGHT	SPREAD	TRUNK DIAMETER	DROUGHT	WIND	
PAN	44,342	<i>Paspalum notatum</i>	Bahia Sod	Solid sod	N/A	N/A	N/A	N/A	As Shown	As Shown	6" to 12"	Runners	N/A	High	High	Yes

PHASE:
 SITE PLAN REVIEW
 100% SUBMISSION

Note: This drawing is protected by copyright. It shall not be transmitted to any other except as agreed to by the Architect/Engineers

SEAL:

REVISIONS:

No.	DESCRIPTION	DATE:

TITLE:

PLANT MATERIAL LIST

Project No:
 Date: 06/03/2022
 Scale: 1" = 20'
 Format: 24" x 36"
 Drawn: RL
 Checked: KJO
 SHEET:

SOD INSTALLATION NOTES

1. ALL PLANTING AREAS AND PLANTING PITS SHALL BE TESTED FOR SUFFICIENT PERCOLATION (AT A RATE OF 1" OF STANDING WATER IN 10 MINUTES) PRIOR TO INSTALLATION OF PLANT MATERIAL TO ENSURE SUFFICIENT DRAINAGE.
2. PLANT BEDS COMPACTED BY EQUIPMENT AND MACHINERY SHALL BE LOOSENED SO THAT THE SPECIFIED DRAINAGE/PERCOLATION RATE IS ACHIEVED.

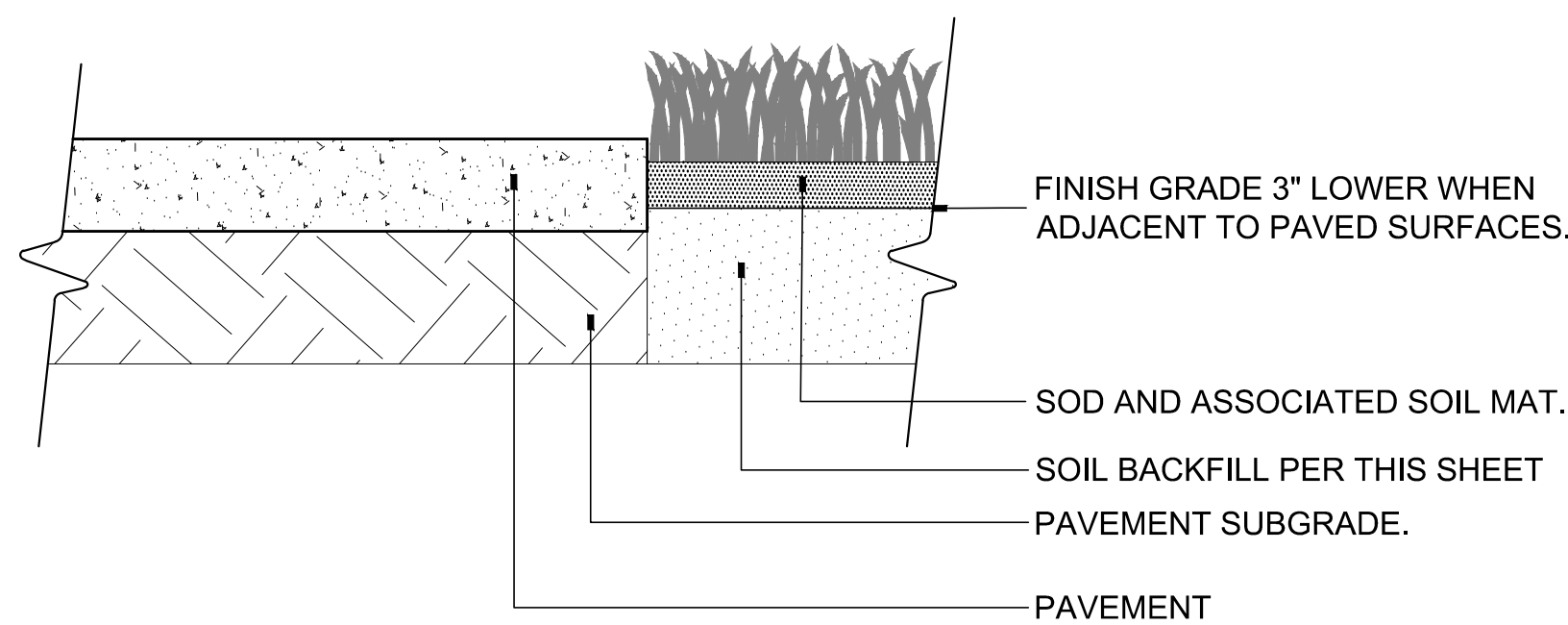

1 SOD INSTALLATION SECTION DETAIL
LL-09 SCALE: 1-1/2" = 1'-0"

SOD SHALL BE LAID IN A STAGGERED MANNER. SOD STRIPS SHALL BE BUTT-JOINTED TIGHTLY AGAINST ONE ANOTHER.

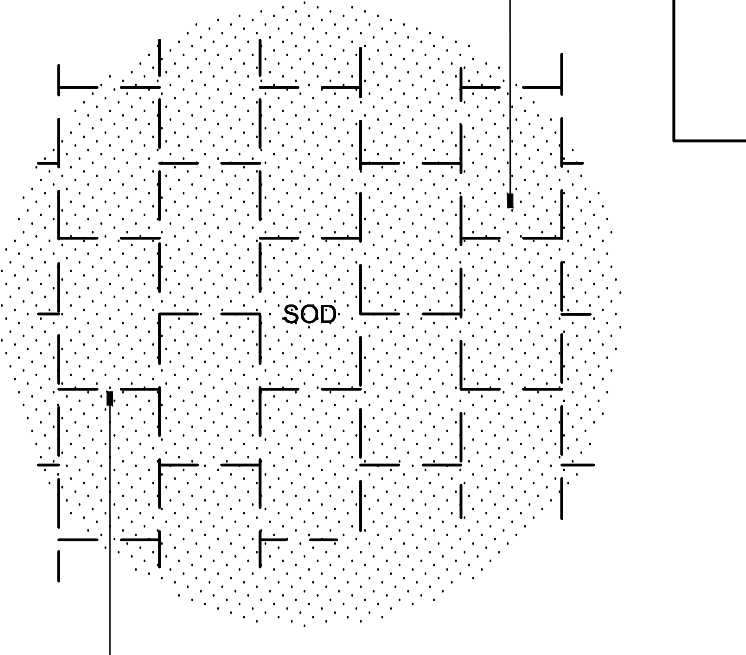

JOINT SPACES THAT ARE GREATER THAN ONE-HALF INCH (1/2") WILL NOT BE ACCEPTED.

SOD LAYOUT AND INSTALLATION NOTES:

1. UNLESS OTHERWISE STATED, WHERE SOD IS PROPOSED ADJACENT TO CURB, SIDEWALKS, FURNITURE PADS OR PAVEMENT, FINISH GRADE SHALL BE 3" LOWER PRIOR TO INSTALLATION OF SAID SOD.

2 SOD LAYOUT AND INSTALLATION DETAIL
LL-09 SCALE: 1/2" = 1'-0"

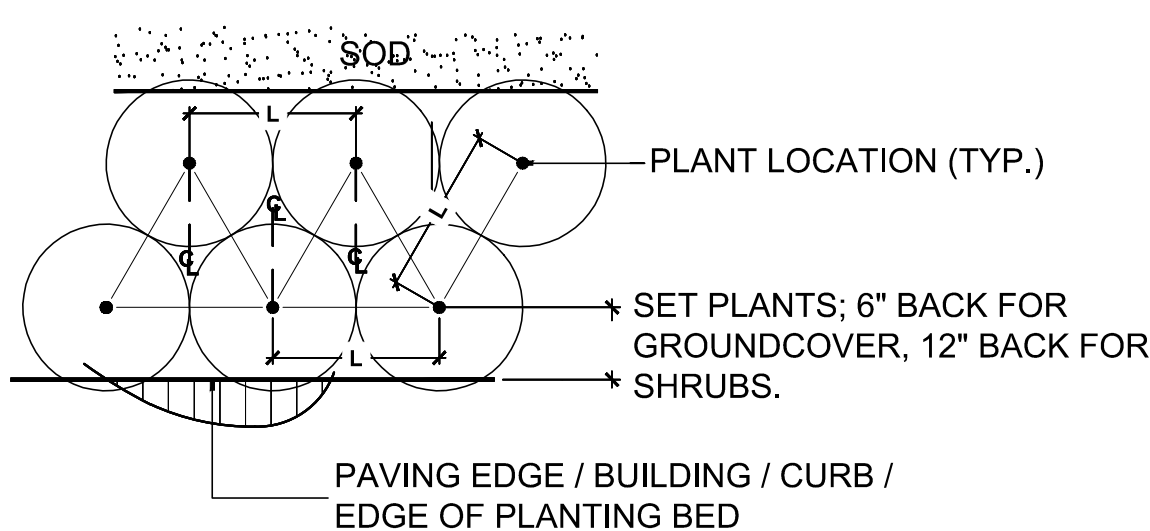

PLANT SPACING NOTES:

1. SPACING DIAGRAM REFERS TO ALL PLANTING UNLESS NOTED OTHERWISE.
2. L= SPACING AS CALLED FOR IN PLANTING PLAN AND PLANT LIST.

3 SHRUB INSTALLATION DETAIL
LL-09 SCALE: 3/4" = 1'-0"

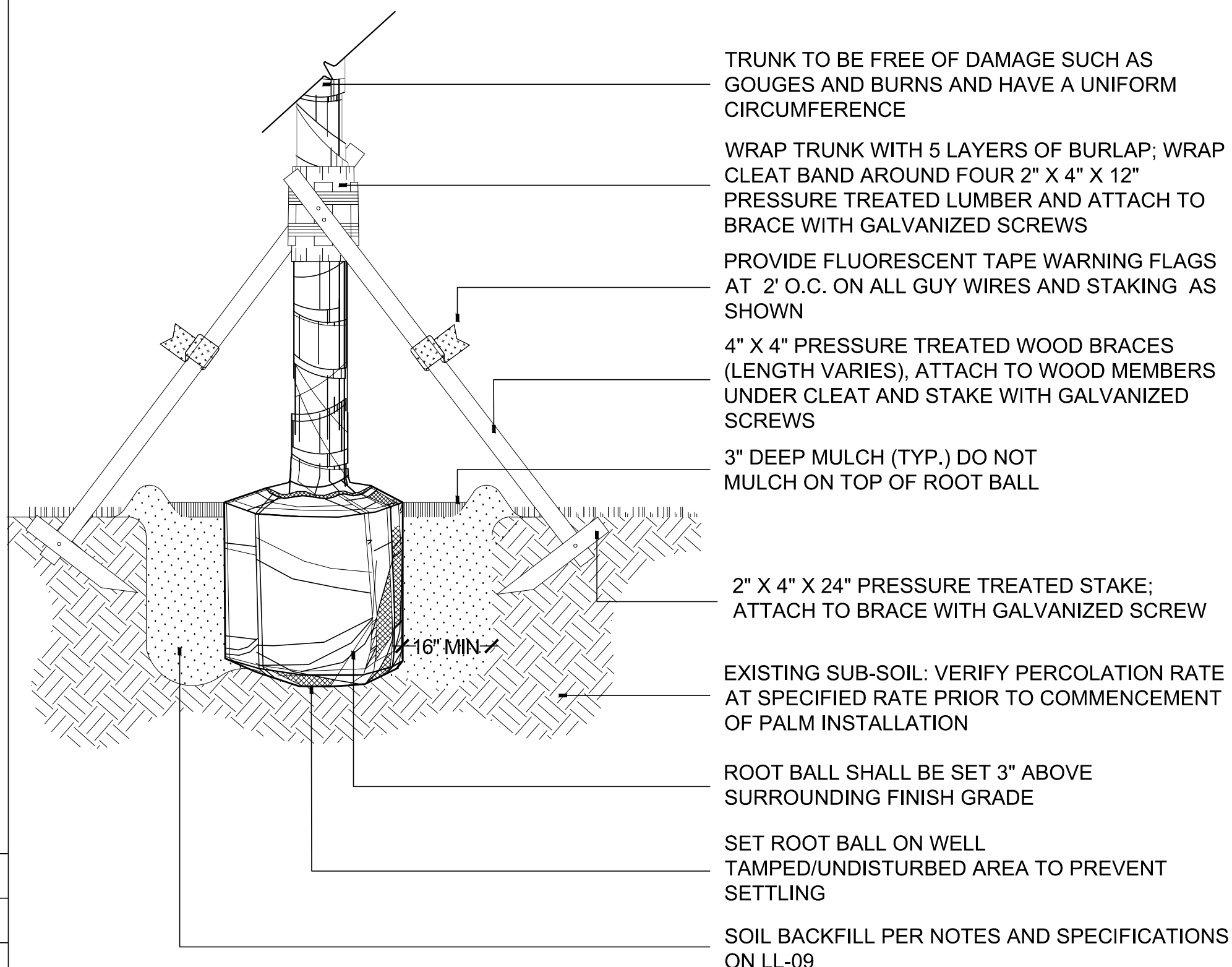

INSTALLATION NOTES:

1. ALL PLANTING AREAS AND PLANTING PITS SHALL BE TESTED FOR SUFFICIENT PERCOLATION (AT A RATE OF 1" OF STANDING WATER IN 10 MINUTES) PRIOR TO INSTALLATION OF PLANT MATERIAL TO ENSURE SUFFICIENT DRAINAGE.
2. PLANT BEDS IN PARKING LOTS AND IN AREAS COMPACTED BY EQUIPMENT AND MACHINERY SHALL BE LOOSENED SO THAT THE SPECIFIED DRAINAGE/PERCOLATION RATE IS ACHIEVED.
3. ALL SYNTHETIC BURLAP, STRING, CORDS OR WIRE BASKETS SHALL BE REMOVED BEFORE TREES ARE PLANTED, WITHOUT BREAKING THE SOIL BALL. ALL SYNTHETIC TAPE SHALL BE REMOVED FROM BRANCHES AND TRUNKS PRIOR TO FINAL ACCEPTANCE. THE TOP 1/3 OF NATURAL BURLAP SHALL BE REMOVED, AFTER THE TREE IS SET IN THE PLANTING HOLE AND BEFORE THE TREES ARE BACKFILLED.

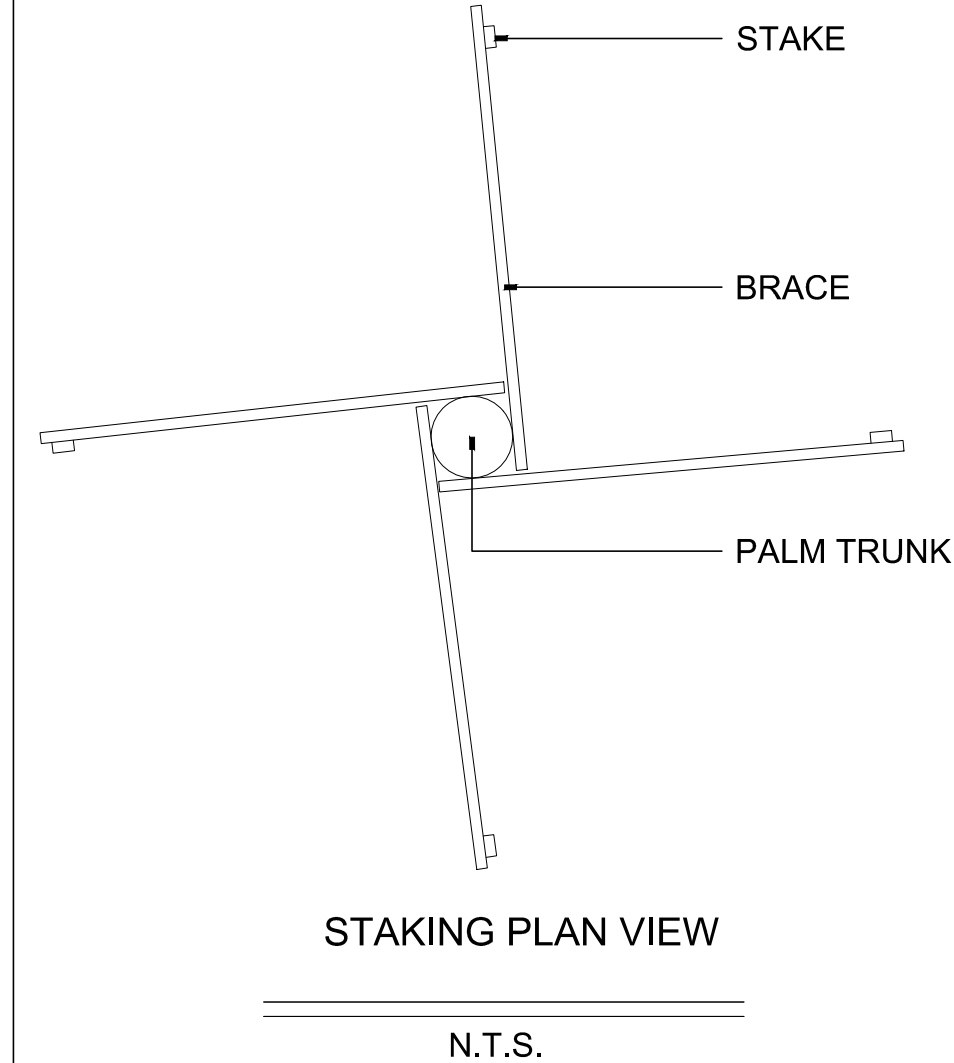

4 TREE AND PALM INSTALLATION DETAIL
LL-09 SCALE: 1/2" = 1'-0"

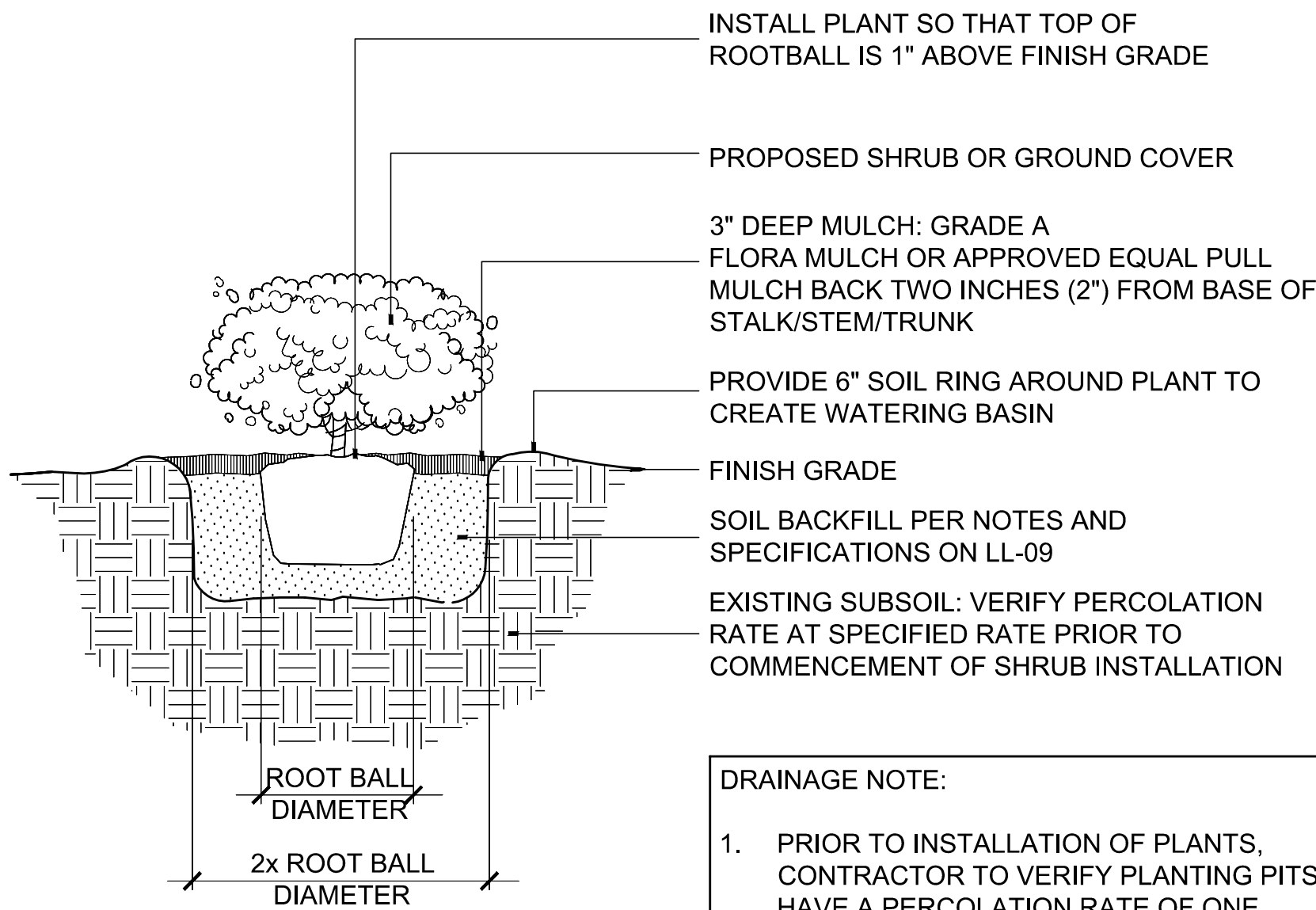

DRAINAGE NOTE:

1. PRIOR TO INSTALLATION OF PLANTS, CONTRACTOR TO VERIFY PLANTING PITS HAVE A PERCOLATION RATE OF ONE INCH (1") OF WATER IN TEN (10) MINUTES.

5 SHRUB AND GROUNDCOVER PLANTING DETAIL
LL-09 SCALE: 1/2" = 1'-0"

1. CONTRACTOR SHALL GUARANTEE THAT ALL PLANT MATERIAL WILL SURVIVE FOR A PERIOD OF ONE YEAR FROM THE DATE OF FINAL ACCEPTANCE.
2. CONTRACTOR IS RESPONSIBLE FOR THE MAINTENANCE AND WATERING OF PLANT MATERIAL UNTIL FINAL ACCEPTANCE.
3. IF NECESSARY FOR PLANT VIGOR, THE CONTRACTOR SHALL PROVIDE TEMPORARY IRRIGATION.
4. CONTRACTOR SHALL SUBMIT WRITTEN MAINTENANCE PLAN FOR ESTABLISHMENT PERIOD (FROM FINAL ACCEPTANCE TO END OF ONE-YEAR GROW-IN PERIOD) INCLUDING WATERING SCHEDULE, IRRIGATION, FERTILIZATION SCHEDULE, PRUNING ETC. TO OWNER'S REPRESENTATIVE.
5. LOCATION OF ALL UTILITIES AND BASE INFORMATION IS APPROXIMATE. CONTRACTOR SHALL VERIFY ALL UNDERGROUND UTILITIES AND OBSTRUCTIONS AND COORDINATE WITH THE OWNER'S REPRESENTATIVE PRIOR TO INITIATING INSTALLATION WORK. CONTRACTOR SHALL BE SOLELY RESPONSIBLE TO REPAIR OR REPLACE ANY DAMAGE COMMITTED TO EXISTING ELEMENTS ABOVE OR BELOW GROUND TO ITS ORIGINAL CONDITION AND TO THE SATISFACTION OF THE THE OWNER'S REPRESENTATIVE.
6. CONTRACTOR SHALL FIELD ADJUST LOCATION OF PLANT MATERIAL AS NECESSARY TO AVOID DAMAGE TO EXISTING UNDERGROUND UTILITIES AND/OR EXISTING ABOVE GROUND ELEMENTS. ALL CHANGES REQUIRED SHALL BE COORDINATED WITH THE OWNER'S REPRESENTATIVE.
7. CONTRACTOR SHALL FIELD STAKE THE LOCATION OF ALL PLANT MATERIAL PRIOR TO INITIATING INSTALLATION FOR THE REVIEW AND APPROVAL OF LANDSCAPE ARCHITECT.
8. CONTRACTOR SHALL CLEAN THE WORK AREAS AT THE END OF EACH WORKING DAY. RUBBISH AND DEBRIS SHALL BE COLLECTED AND DISPOSED OF, AS DIRECTED, DAILY. ALL MATERIALS, PRODUCTS, AND EQUIPMENT SHALL BE STORED IN AN ORGANIZED FASHION AS DIRECTED BY THE OWNER'S REPRESENTATIVE.
9. ALL PLANT MATERIAL SHALL BE IN FULL AND STRICT ACCORDANCE WITH FLORIDA NO. 1 GRADE, ACCORDING TO THE "GRADES AND STANDARDS FOR NURSERY PLANTS" PUBLISHED BY THE FLORIDA DEPARTMENT OF AGRICULTURE AND CONSUMER SERVICES. ALL PLANT MATERIAL SHALL BE FLORIDA No. 1 AT THE TIME OF SUBSTANTIAL COMPLETION; OR IT SHALL BE REJECTED.
10. CONTRACTOR AND EMPLOYEE VEHICLE PARKING SHALL BE COORDINATED WITH THE OWNER'S REPRESENTATIVE. SHUTTLING OF EMPLOYEES TO THE PROJECT AREA(S) SHALL BE THE RESPONSIBILITY OF THE CONTRACTOR. CONTRACTOR SHALL NOT DISRUPT OR CONFLICT IN ANY WAY WITH VEHICULAR TRAFFIC.
11. CONSTRUCTION ACCESS SHALL BE INDICATED BY THE OWNER'S REPRESENTATIVE. COORDINATION OF HEAVY EQUIPMENT AND MATERIALS SHALL BE THE CONTRACTOR'S RESPONSIBILITY. THE CONTRACTOR SHALL BE RESPONSIBLE FOR SCHEDULING AND COORDINATION OF WORK WITH OTHER TRADES.
12. THE CONTRACTOR SHALL TAKE THE NECESSARY MEANS TO FULLY UNDERSTAND ALL THE ACCESS ROUTES, CONSTRUCTION SCHEDULES, AND SECURITY CLEARANCES IN ORDER TO PROVIDE A COMPLETE AND FINISHED PROJECT ON SCHEDULE.
13. ONCE PLANT MATERIAL IS INSTALLED, IF DRAINAGE PROBLEMS EXIST, IT IS THE CONTRACTOR'S RESPONSIBILITY IF NEEDED, TO REMOVE ALL PLANTS, RE-GRADE THE AREA AND RE-PLANT AT NO EXTRA COST.
14. THE CONTRACTOR IS RESPONSIBLE FOR PROVIDING THE PLANT SIZES AS SPECIFIED. IT IS UP TO THE CONTRACTOR TO DETERMINE PRICING WHETHER THE PLANT IS BALL AND BURLAP OR CONTAINERIZED.
15. SHRUB AND GROUND COVER BED QUANTITIES ARE INDICATED FOR EACH PLANT BED.
16. SHRUB AND GROUND COVER SPACING IS INDICATED ON THE PLANT LIST, UNDER "SPACING," AND SHALL APPLY FOR ALL "MASS PLANTINGS." TREES, PALMS AND ACCENT PLANT SPACING, IS INDICATED ON THE PLANT LIST AS "AS SHOWN" AND DELINEATED AS INDIVIDUAL PLANTS. SHRUB AND GROUND COVER SPACING SHALL SUPERSEDE QUANTITY TO FILL PLANTING BED.
17. PALM HEIGHTS AS INDICATED ON THE PLANS REFER TO "CLEAR TRUNK" HEIGHTS, UNLESS OTHERWISE NOTED AS "OA" (OVERALL HEIGHT), OR "GW" (GRAY WOOD). (DATE PALM CLEAR TRUNK SIZE DOES NOT INCLUDE THE NUT.)
18. CONTRACTOR SHALL MULCH ALL NEW PLANT MATERIAL THROUGHOUT AND COMPLETELY TO DEPTH SPECIFIED.
19. ANY SUBSTITUTIONS IN SIZE AND/OR PLANT MATERIAL MUST BE APPROVED BY THE LANDSCAPE ARCHITECT. ALL PLANTS WILL BE SUBJECT TO APPROVAL BY THE LANDSCAPE ARCHITECT BEFORE PLANTING CAN BEGIN.
20. CONTRACTOR SHALL BE RESPONSIBLE FOR ALL HAND WATERING ALL NEW LANDSCAPE FOR A PERIOD NOT LESS THAN 180 DAYS FROM DATE OF FINAL ACCEPTANCE BY THE CITY.
21. CONTRACTOR SHALL REPLACE (BY EQUAL SIZE AND QUALITY) ANY AND ALL EXISTING PLANT MATERIAL DISTURBED OR DAMAGED BY PLANT REMOVAL, RELOCATION, AND/OR INSTALLATION WORK.
22. CONTRACTOR IS RESPONSIBLE FOR EXCAVATING AND DISPOSING OF ALL COMPACTED MATERIAL, COMPACTED ROCK, RUBBISH AND DEBRIS IN MEDIAN PLANTING BEDS TO A DEPTH OF 36" BELOW ADJACENT CURB. CONTRACTOR SHALL VERIFY PERCOLATION RATE AND EXCAVATE FURTHER UNTIL RATES ARE ACHIEVED. CONTRACTOR SHALL THEN BACKFILL WITH "SOIL BACKFILL" AS DESCRIBED ON THIS SHEET.
23. ANY DAMAGE CAUSED TO SIDEWALKS OR CURBS SHALL BE THE CONTRACTORS RESPONSIBILITY TO REPLACE TO THE SATISFACTION OF THE OWNER AND NOT A CAUSE FOR CHANGE ORDER FOR TIME OR MATERIALS.
24. THE ROOT BALL OF CONTAINERIZED TREES SHALL BE SHAVED TO REMOVE ALL CIRCLING ROOTS.

6 LANDSCAPE NOTES
LL-09 SCALE:

1. SOIL BACKFILL SHALL BE NATURAL SURFACE SOIL FROM WELL-DRAINED AREAS, FERTILE, FRIABLE AND FREE OF WEEDS AND TYPICAL OF PRODUCTIVE, CULTIVATED TOPSOIL; POSSESSING CHARACTERISTICS REPRESENTATIVE OF A WELL-DRAINED AREA IN FLORIDA.
2. SOIL CONTAINING MUCK OR POORLY-DRAINED SOILS SHALL NOT BE USED.
3. SOIL BACKFILL SHALL NOT BE EXCESSIVELY ACID OR ALKALINE (PH 5.5 TO 7.0), NOR CONTAIN TOXIC SUBSTANCES SUCH AS LEAD OR MERCURY.
4. SOIL BACKFILL SHALL BE REASONABLY FREE OF CLAY, STONES, STICKS, STUMPS, ROOTS, OR OTHER SIMILAR SUBSTANCES ONE-QUARTER-INCH (1/4") OR MORE IN DIAMETER OR ANY OTHER OBJECT WHICH MAY BE A HINDRANCE TO THE FINISH-GRADING OPERATION OR DETRIMENTAL OR INJURIOUS TO PLANTS. PARTICULAR CARE SHOULD BE TAKEN TO REMOVE PIECES OF MORTAR, CEMENT, WOOD, ROAD ROCK, LIME ROCK CHUNKS AND OTHER SIMILAR REMAINS OF CONSTRUCTION FROM ALL PLANTING AREAS.
5. SOIL BACKFILL SHALL BE 70% SCREENED TOPSOIL AND 30% ORGANIC COMPOST.
6. PRIOR TO INSTALLATION OF PLANT MATERIAL, ALL PLANTING AREAS SHALL BE CLEANED OF ALL CONSTRUCTION DEBRIS OR MATERIAL INJURIOUS TO PLANTS OR THAT INHIBIT VIGOROUS GROWTH. SEE LL-05 FOR ESTIMATED EXCAVATION.

7 SOIL BACKFILL NOTES AND SPECS
LL-09 SCALE: N/A



LANDSCAPE ARCHITECT
Bermello Ajamil & Partners
2801 S Bayshore Drive, Suite 1000
Miami, FL 33133
P: 305.859.2050

CIVIL ENGINEER:
Bermello Ajamil & Partners
2801 S Bayshore Drive, Suite 1000
Miami, FL 33133
P: 305.859.2050

SOUTH ROYAL POINCIANA BLVD., MIAMI SPRINGS, FLORIDA
AHCA: 23/100154-267-1

SOUTH ROYAL POINCIANA CITY OF MIAMI SPRINGS, MIAMI-DADE, FLORIDA

PHASE:
SITE PLAN REVIEW
100% SUBMISSION

Note: This drawing is protected by copyright. It shall not be transmitted to any other except as agreed to by the Architect/Engineers

SEAL:

REVISIONS:
No. DESCRIPTION DATE:

No.	DESCRIPTION	DATE:

TITLE:

PLANTING DETAILS AND NOTES

Project No:
Date: 06/03/2022
Scale: 1" = 20'
Format: 24" x 36"
Drawn: RL
Checked: KJO
SHEET:

LL-09

**SOUTH ROYAL POINCIANA
 CITY OF MIAMI SPRINGS, MIAMI-DADE, FLORIDA**

SOUTH ROYAL POINCIANA BLVD., MIAMI SPRINGS, FLORIDA
 AHCA: 23/100154-267-1

PHASE:
**SITE PLAN REVIEW
 100% SUBMISSION**

Note: This drawing is protected by copyright. It shall not be transmitted to any other except as agreed to by the Architect/Engineers

SEAL:

REVISIONS:

No.	DESCRIPTION	DATE

TITLE:
**TREE
 PROTECTION
 DETAILS AND
 NOTES**

Project No:
 Date: 06/03/2022
 Scale: 1" = 20'
 Format: 24" x 36"
 Drawn: RL
 Checked: KJO
 SHEET:

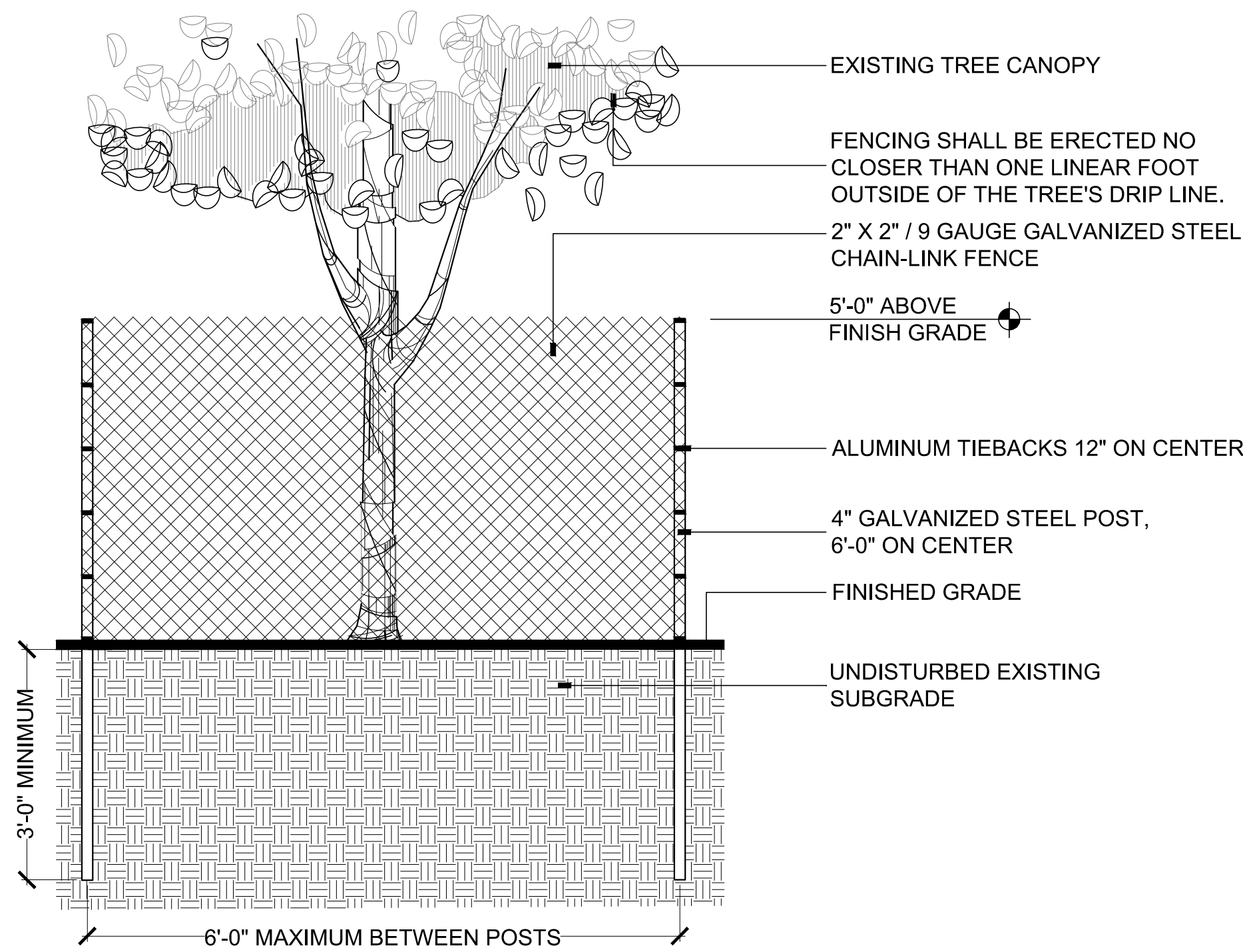

NOTE: BARRIER TO BE CONTINUOUS AROUND THE TREE OR GROUP OF TREES. SEE LANDSCAPE PLAN FOR LOCATION OF TREES TO REMAIN

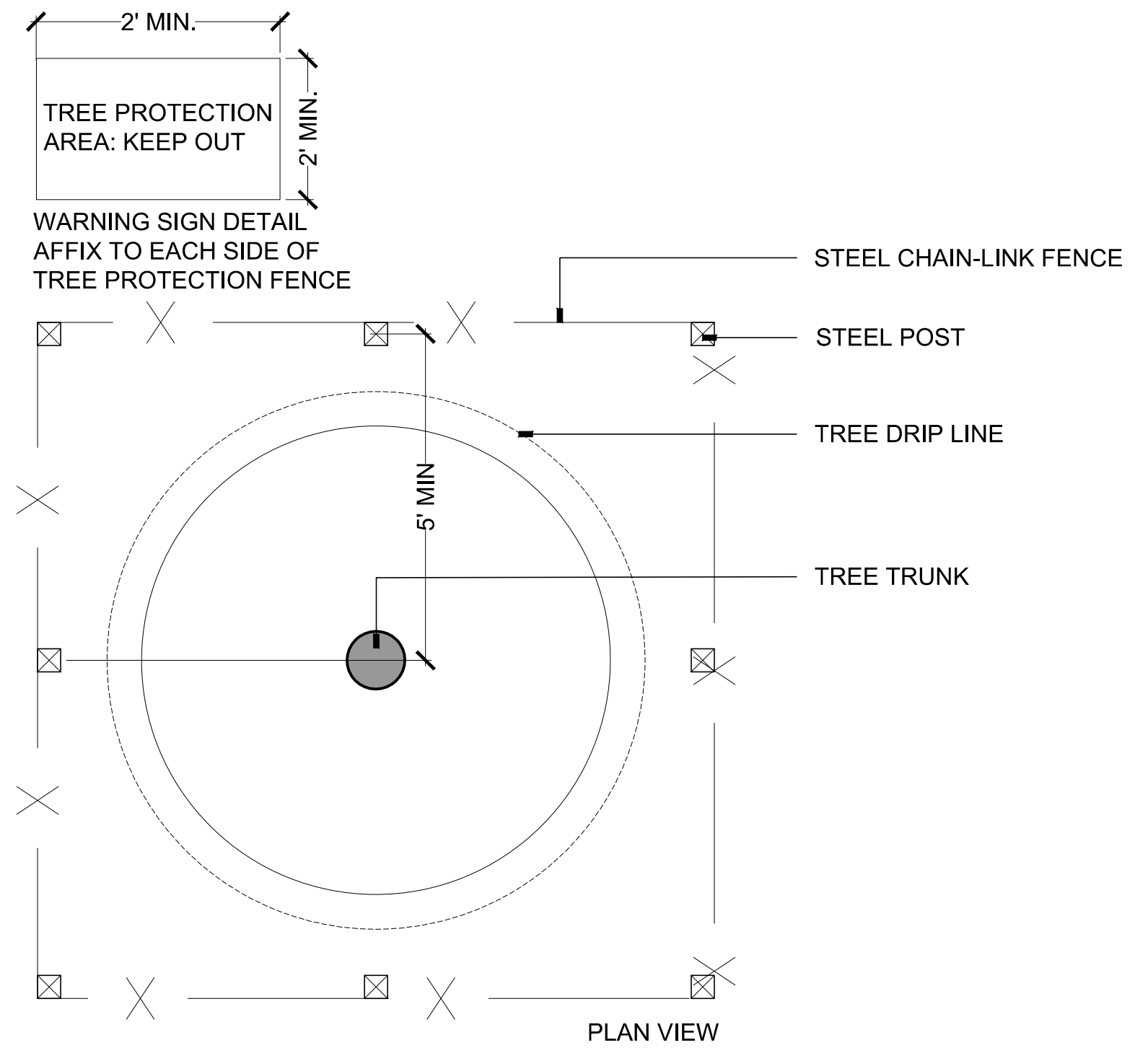

- IT IS THE CONTRACTOR'S RESPONSIBILITY TO NOTE AND PROTECT THE EXISTING TREES TO REMAIN ON SITE.
- CONTRACTOR SHALL INSTALL A PERMANENT RIGID BARRIER PRIOR TO COMMENCEMENT OF WORK TO PROTECT THE CANOPY, TRUNK AND OR ROOT SYSTEM FROM DAMAGE.
- PROTECTION INCLUDES BUT IS NOT LIMITED TO THE PROHIBITION OF THE FOLLOWING ACTIVITIES UNDER THE CANOPY: STORING OF EQUIPMENT, STOCK PILING OF MATERIALS, TRASH OR DEBRIS AND STORING OF TRAILERS, MACHINERY AND OR VEHICLES.
- PRIOR TO COMMENCEMENT OF ANY WORK, CONTRACTOR SHALL PERFORM ROUTINE MAINTENANCE PER ANSI A300. ON THE EXISTING TREES SHOWN TO REMAIN. THIS INCLUDES REMOVAL OF DEAD/DECAYED WOOD, REMOVAL OF ATTACHED BRANCHES AND STRUCTURALLY UNSOUND LIMBS AS WELL AS REMOVAL OF SUBORDINATED BRANCHES. WHERE INCLUDED BARK IS PRESENT REMOVE BRANCHES AS NEEDED TO INCREASE LIGHT AND AIR PENETRATION WITHIN THE CANOPY. UNDER NO CIRCUMSTANCES SHALL MORE THAN 25% OF ANY CANOPY BE REMOVED IN A TWELVE MONTH PERIOD. REDUCTION OF OVERALL CANOPY SIZE IS PROHIBITED.
- PER ANSI A300, CONTRACTOR SHALL REMOVE DEAD BRANCHES AND SUCKERS FROM PRESERVED TREES.
- PER ANSI A300, CONTRACTOR SHALL REMOVE RIPPED, TORN OR "LION TAILED" BRANCHES FROM PRESERVED TREES.
- PRIOR TO COMMENCEMENT OF WORK, THE CONTRACTOR UNDER THE DIRECTION OF A CERTIFIED ASCA ARBORIST, SHALL PERFORM AN INTERNAL DECAY SURVEY AND INSPECTION AND PROVIDE A WRITTEN REPORT OF FINDINGS TO THE OWNER'S REPRESENTATIVE. IF IT IS DEEMED NECESSARY TO REMOVE ANY EXISTING TREES THAT ARE NOTED AS "REMAIN," THE CONTRACTOR SHALL BE RESPONSIBLE FOR APPLYING FOR THE APPROPRIATE TREE REMOVAL LICENSE REQUIRED BY LOCAL CODES, LAWS AND OR REGULATIONS.
- WHERE CONSTRUCTION ACTIVITIES REQUIRE IMPACT TO EXISTING TREE ROOT SYSTEMS, THE CONTRACTOR, UNDER THE GUIDANCE OF AN ASCA ARBORIST, SHALL ROOT PRUNE TREES IN THE IMPACTED AREAS PER ANSI A300 STANDARDS. THE CONTRACTOR, AS WELL AS HIS/HER APPOINTED REGISTERED ASCA ARBORIST, SHALL TAKE ANY AND ALL CUSTOMARY PRECAUTIONS NECESSARY FOR THE SURVIVAL AND CONTINUED VIGOROUS GROWTH OF SAID TREES TO REMAIN.
- ANY REQUIRED ROOT PRUNING SHALL BE COMPLETED PRIOR TO COMMENCEMENT OF ANY CONSTRUCTION ACTIVITIES. UNDER NO CIRCUMSTANCE SHALL THE ROOT SYSTEM BE SUBJECT TO COMPACTION, TEARING, RIPPING OR ANY OTHER DAMAGE EXCEPT CLEAN CUTS AS DESCRIBED IN ANSI A300.
- TREE SHALL BE ROOT PRUNED IN THIRDS AND RELOCATED 6 MONTHS AFTER INITIAL PRUNING ACTIVITY.
- IF MORE THAN 25% OF AN EXISTING TREE ROOT SYSTEM IS IMPACTED FOR ANY REASON (IMPLIED IN THE DRAWINGS OR INCIDENTAL), THE CONTRACTOR SHALL BRACE THE TREE PER DETAIL 3 ON THIS SHEET.
- ANY TREE WITH AN IMPACTED ROOT SYSTEM SHALL BE WATERED DAILY AS DESCRIBED ON THIS SHEET.
- ALL ACTIVITY UNDER DRIP LINES AND IN THE PROXIMITY OF PRESERVED TREES SHALL BE ACCOMPLISHED BY NON-MECHANICAL METHODS.
- CONTRACTOR SHALL PROVIDE 3" MULCH UNDER AND AROUND THE BASE OF ALL PRESERVED TREES.

**SOUTH ROYAL POINCIANA
 CITY OF MIAMI SPRINGS, MIAMI-DADE, FLORIDA**
 SOUTH ROYAL POINCIANA BLVD, MIAMI SPRINGS, FLORIDA
 AHCA: 23/100154-267-1

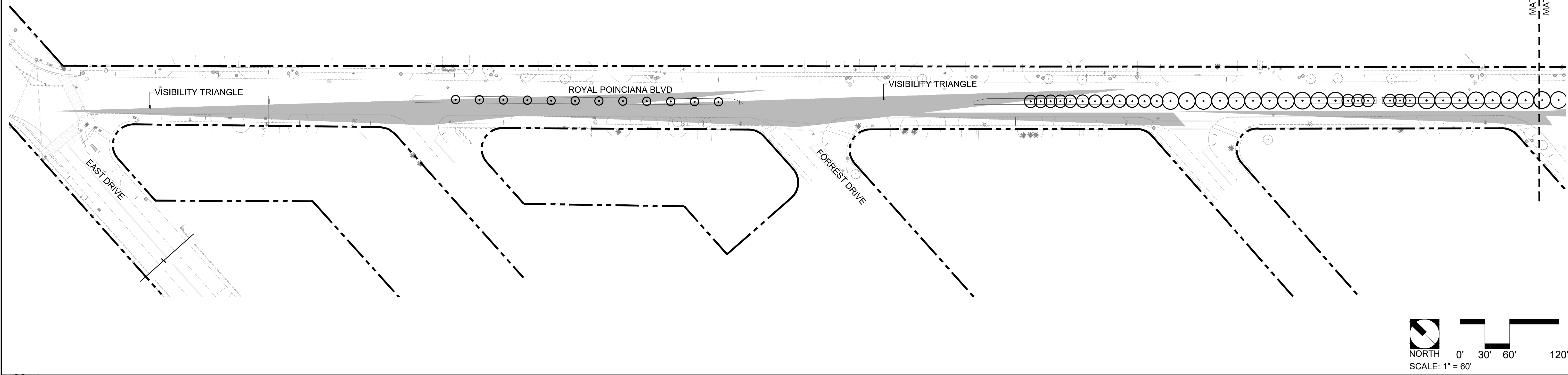

1 VISIBILITY TRIANGLE DIAGRAM A
 LL-11 SCALE: AS SHOWN

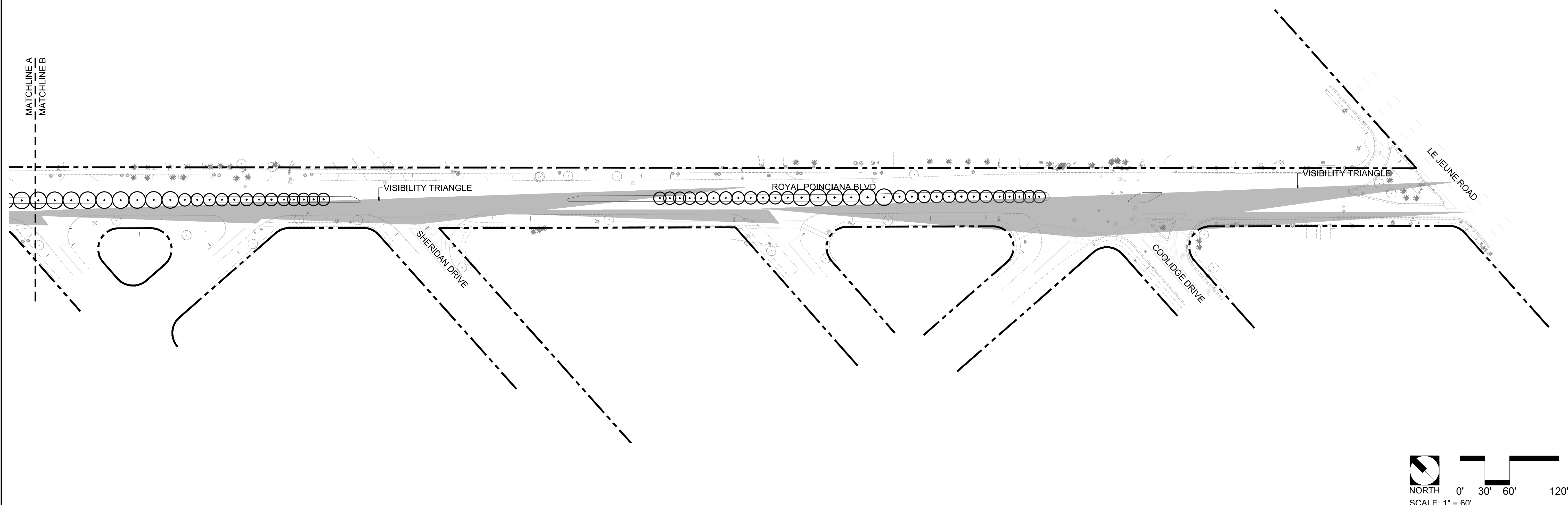

2 VISIBILITY TRIANGLE DIAGRAM B
 LL-11 SCALE: AS SHOWN

PHASE:
**SITE PLAN REVIEW
 100% SUBMISSION**

Note: This drawing is protected by copyright. It shall not be transmitted to any other except as agreed to by the Architect/Engineers

SEAL:

REVISIONS:

No.	DESCRIPTION	DATE

TITLE:
**VISIBILITY
 DIAGRAM
 TRIANGLE**

Project No:
 Date: 06/03/2022
 Scale: 1" = 20'
 Format: 24" x 36"
 Drawn: RL
 Checked: KJO
 SHEET:

LL-11